



***AEROSPACE SYSTEMS***

**MARPOSS**

Kern has been established in 1954 to answer properly to the growing requests of specific tools and gauges in strategic industrial sectors such as aerospace and automotive, where the quality requirements are extremely important.

The company belongs to Marposs group from 2008.

Marposs has many years experience in the design and manufacture of tooling, fixtures, machine monitoring systems and automatic inspection machines that perform checks on specific parts, used on aeronautics and space sectors. Measuring components, masters and electronics used in the equipment are 100% manufactured by Marposs, giving us control over the quality and integrity of the essential building blocks of the equipment. Marposs systems are used for assembly, final inspection and MRO of almost every modern aircraft engine manufactured (e.g.: M88 Rafale, CFM56 (GE/Snecma), GE90 (for Boeing 777), GP7000 (for Airbus A380), SaM146, Silvercrest, LEAP-X). Over the last few decades, we have supplied thousands of gauging/tools systems to customers worldwide; the most of any gauge manufacturer in the world. Marposs is present in 34 countries with its 80 offices and productions sites, and as approx. 3500 employees.



Marposs France - Chelles (France)



Marposs Headquarters - Bentivoglio (BO) - Italy



## AIRCRAFT ENGINES COMPONENTS GAUGING

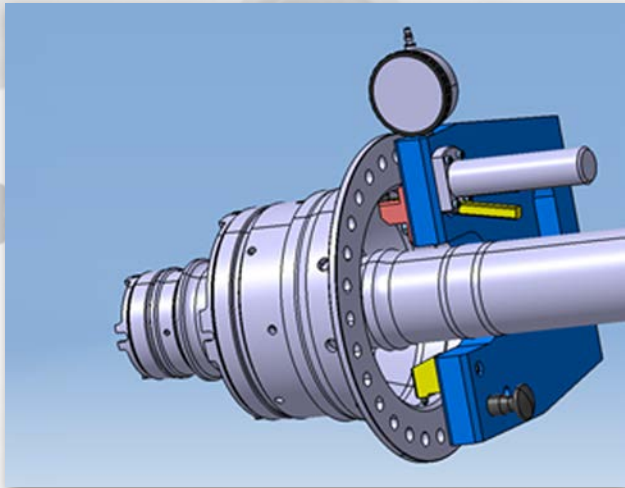

Manual gauging fork for the inspection of the rotor ID, with dual handle and dial indicator

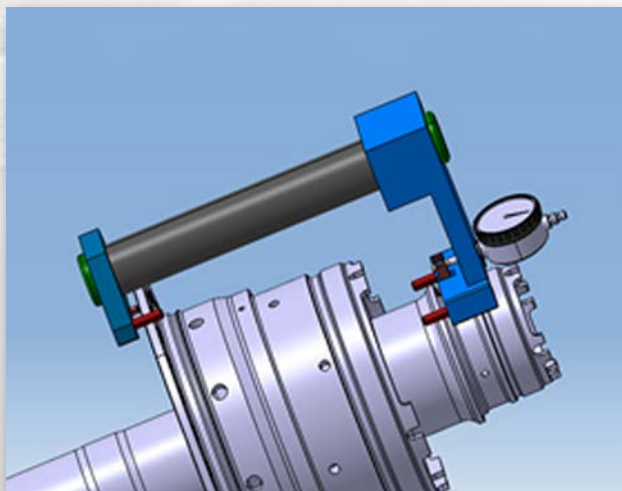

Manual gauging caliper in carbon fiber for the inspection of the turbine shaft length (up to 700 mm) with dial indicator

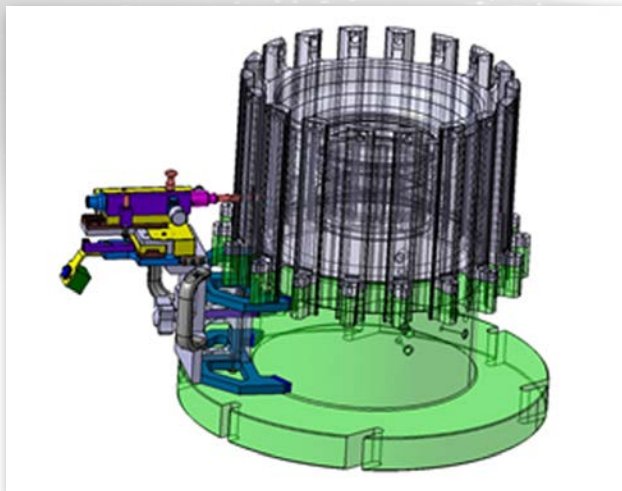

Manual profile scanner for the seat cross section of the high pressure drum module

## AIRCRAFT ENGINES COMPONENTS GAUGING

Gauging station for fan blade profile measurement, with up to 67 contacts

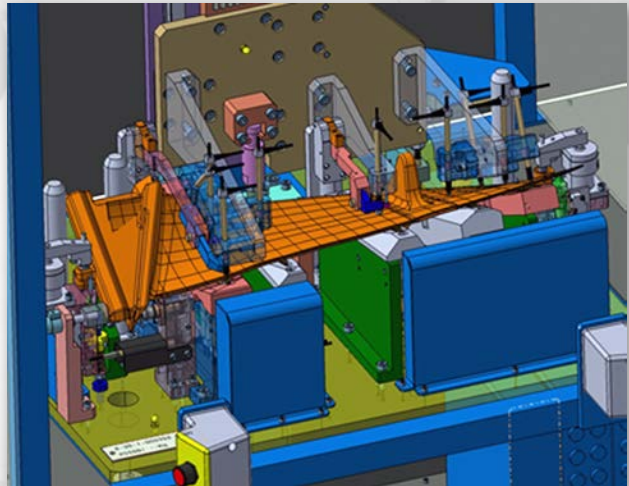

Gauging station for engine cover dimensional measurement

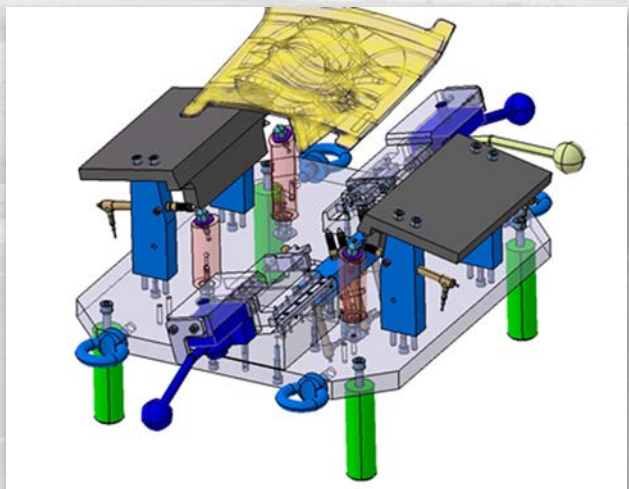

Gauging station for turbine ring slot measurement, with dial indicators

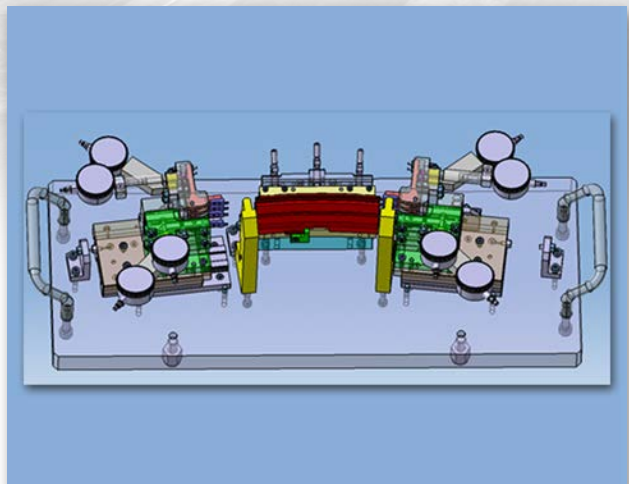

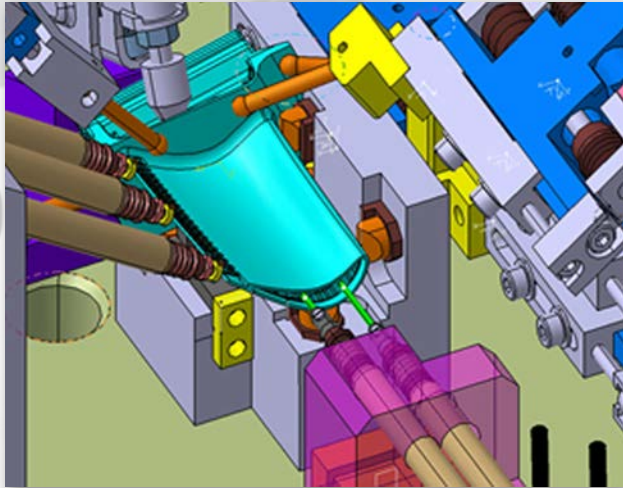

Gauging station for turbine blade measurement with electronic probes

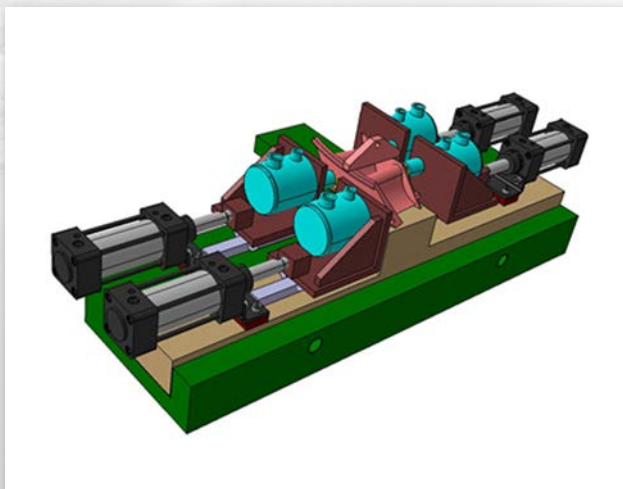

Airflow testing on repaired vanes

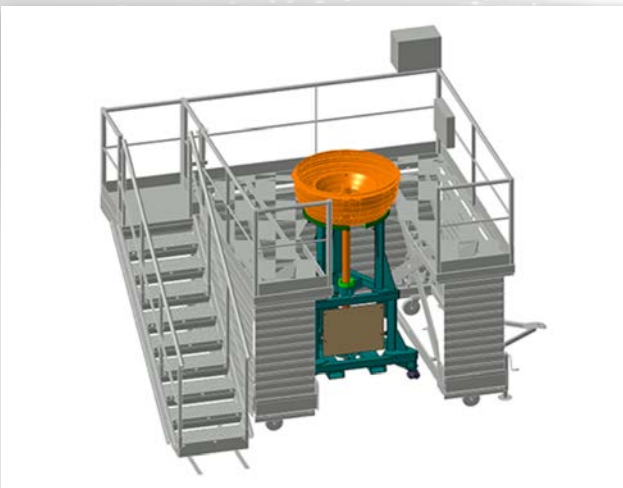

Platform and support for engine assembly. Low Pressure Turbine rotor and stator verification to turbine shaft

## TOOLS FOR AIRCRAFT ENGINES MRO

Holder for Low Pressure  
Turbine's nozzle  
segment assembly

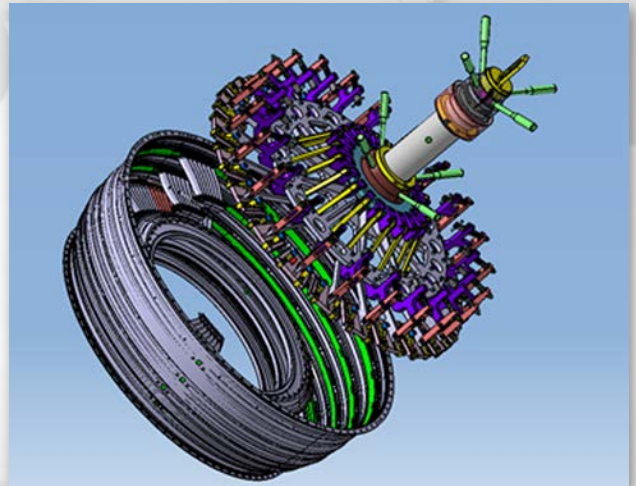

Fixture holder for exhaust  
and combustor assembly

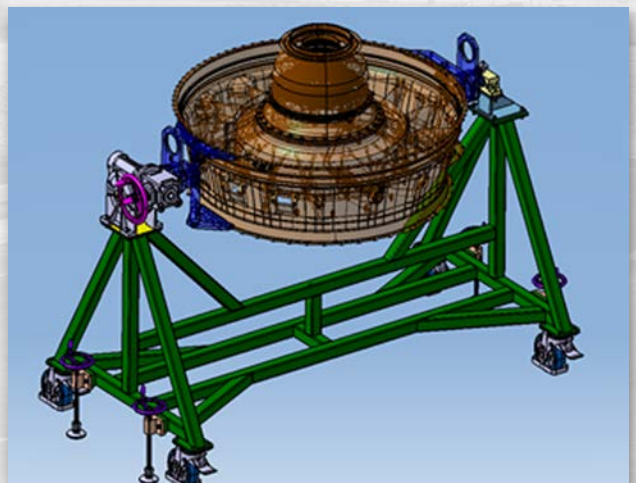

Low Pressure Turbine  
blades mounting fixture

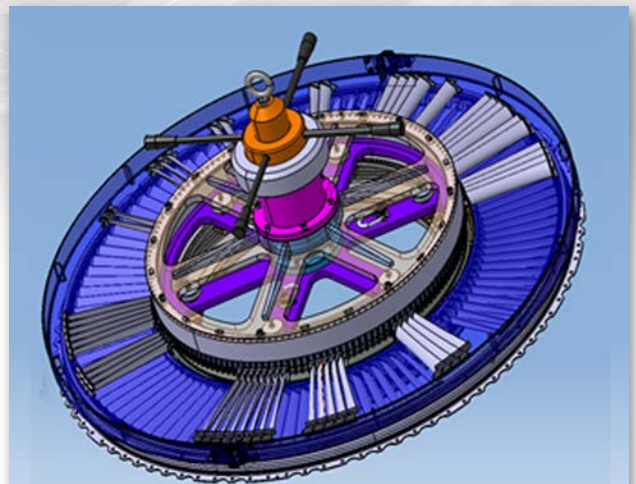

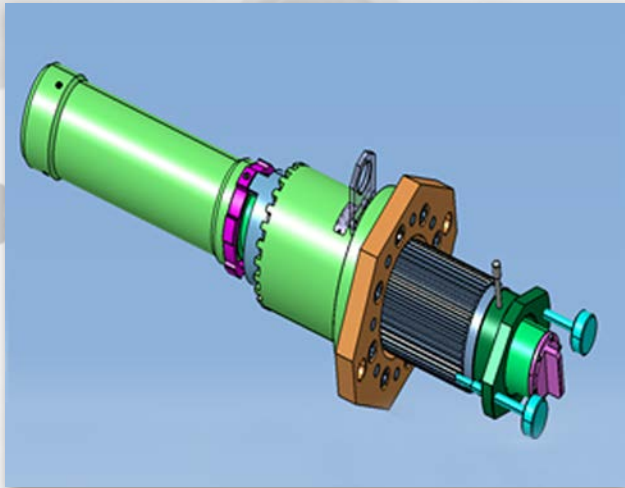

Engine assembly  
special wrench

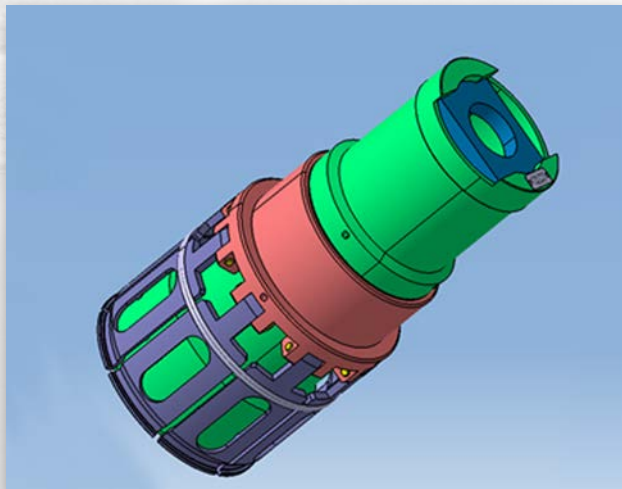

Special tool for High  
Pressure stage assembly

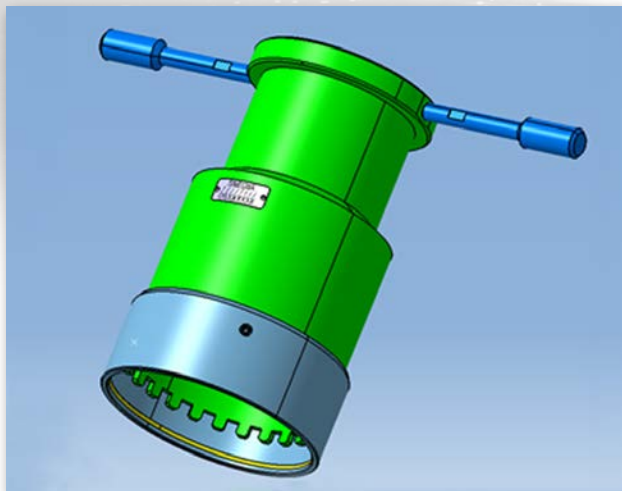

Extractor for fan  
blade rotor



Marposs in the world:  
[www.marposs.com/addresses](http://www.marposs.com/addresses)