

MARPOSS

QUICKREAD

COMPACT ELECTRONIC DISPLAY UNIT



Indicators and electronic display units

Quick Read™ is a 12 mm slim, compact display unit, with analog and digital displays, easily programmed via local keypad. It allows to connect half-bridge (HBT) standard sensors, manufactured by Marposs or by Tesa, with measuring range from $\pm 0,25$ mm to ± 5 mm. The 3-colour (green, yellow and red) analog display and 8-digit alphanumeric display provide clear definition and easy reading of the measurement results.

Product features

Two versions are available :

- For connection of one sensor to carry out one static measurement .
- For connection of one or two sensors to carry out one static or dynamic measurement [Hold, Max, min, Max-min, (Max-min)/2, (Max+min)/2]. To connect two sensors the specific Y-cable is needed.

FOR CONNECTION OF ONE SENSOR
ONE STATIC MEASUREMENT



FOR CONNECTION OF ONE OR TWO SENSORS
ONE STATIC OR DYNAMIC MEASUREMENT



QUICKREAD

Using the local keypad, the Quick Read™ can be easily programmed to set the digital display resolution, measuring unit, tolerance limits, master deviation, full scale, measurement multiplying coefficient, absolute or comparative reading of the measurement result and the data format for serial transmission.

The RS232 output port allows for connection to a PC, statistical printer or data collector for SPC purposes, and to a PLC (data can be sent in ASCII or binary format).



TECHNICAL SPECIFICATIONS

General specifications

Dimensions of the case	110 x 69 x 12 mm (4.33" x 2.72" x 0.47")
Power supply	7 - 7,5 Vdc ± 5% (300 mA)
Protection level	IP50
Accuracy	± (1% reading value + resolution)
Measurement thermal drift	0,1 µm/°C for range up to ± 1 mm (0.04"); 0,2 µm/°C for range ± 2,5 mm (0.1") and ± 5 mm (0.2")
Output	RS232
Working temperature	0 to 50 °C
Storage temperature	- 40 to 50 °C

Digital display

Resolution	0,0001/0,001 mm (0.00001"/0.00005") for measuring range up to ± 1 mm (0.04"); 0,001 mm (0.00005") for range ± 2,5 (0.1") and ± 5 mm (0.2")
Type	8 alphanumeric digits
Measurement multiplying coefficient	-2 to +2 with 0,01 step

Analog display

Available scales	auto; 0,010 mm (0.0005"); 0,020 mm (0.001"); 0,050 mm (0.0025"); 0,100 mm (0.005"); 0,250 mm (0.01"); 0,500 mm (0.025"); 1,000 mm (0.05"); 2,5 mm (0.1"); 5 mm (0.25"); 10 mm (0.5")
Resolution	1/10 of the programmed scale, from 0,001 mm (.00005") to 1,000 mm (0.05")
Type	21 three colour LEDs (green, yellow, red)

Displacement
Sensors



Bore Gauges
Line



Forks and
Ring Gauges



Bench
Gauges



Indicators and
Electronic
Display Units



Interface
Boxes for Data
Acquisition



Software



HOW TO ORDER

Description	Order code
QUICK READ for one sensor (one static measurement)	B0E01991650
QUICK READ for one or two sensors (one static or dynamic measurement)	B0E01991660
QUICK READ for one or two sensors compatible to Tesa amplifiers (one static or dynamic measurement)	B0E01991670
Y-cable for connection of two sensors	B6735532001

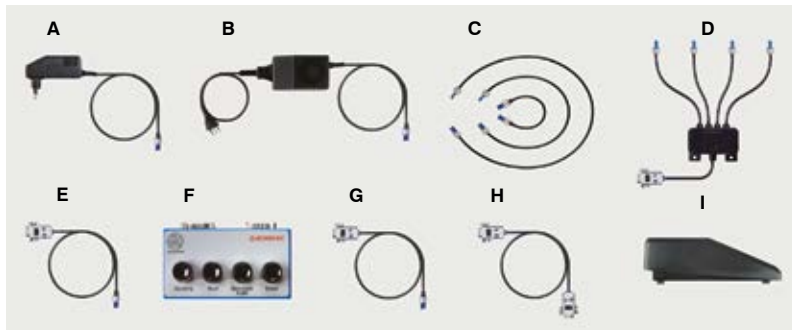
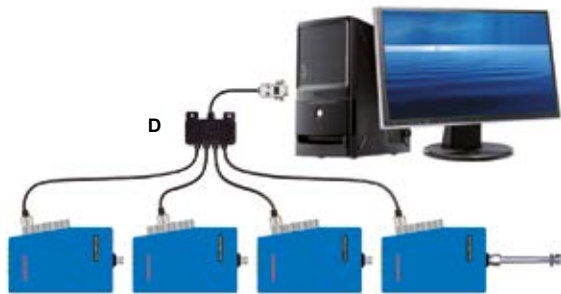
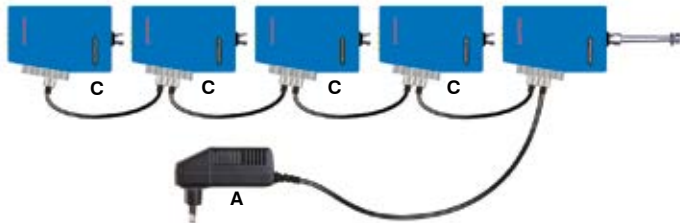

Ref.	Description	Order code
A	Power supply unit for max. 5 Quick Read, with EU plug	B6871140067
	Power supply unit for max. 5 Quick Read, with U.S. / JP plug	B6871140068
	Power supply unit for max. 5 Quick Read, with U.K. plug	B6871140069
B	Power supply unit for max. 5 Quick Read, with EU mains cable	B6871140070
	Power supply unit for max. 5 Quick Read, with U.S. / JP mains cable	B6871140071
	Power supply unit for max. 5 Quick Read, with U.K. mains cable	B6871140072
C	Power jumper cable L = 150 mm	B6739696138
	Power jumper cable L = 300 mm	B6739696128
	Power jumper cable L = 600 mm	B6739696129
D	Chain serial cable (L = 4 m) for connection of up to 4 Quick Read to pushbutton box, footswitch or PC (9 pins); distance between Quick Read = 1m	B6739696396
E	Serial cable (L = 2 m) for connection of one Quick Read to pushbutton box, footswitch or PC (9 pins)	B6739696157
F	Pushbutton box for remote control of zeroing, dyn. cycle and data transmission to PC	B6139013100
G	Power supply cable (L = 2 m) for pushbutton box [power feed is from Quick Read]	B6739696301
H	Serial cable (L = 3 m) to connect pushbutton box to PC (9 pins)	B6737957002
I	Footswitch with 1,5 m cable for connection to pushbutton box or to Quick Read (in this case cable E is needed)	B6738099030
M	Stand (holds up to 10 units)	B2919916500

Displacement
Sensors



Bore Gauges
Line



Forks and
Ring Gauges



Bench
Gauges



Indicators and
Electronic
Display Units



Interface
Boxes for Data
Acquisition



Software



Application examples

Displacement
Sensors



Bore Gauges
Line



Forks and
Ring Gauges



Bench
Gauges



Indicators and
Electronic
Display Units



Interface
Boxes for Data
Acquisition



Software

