

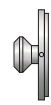



Touch Probes
Transmission Systems
Laser
Software
Toolsetting Arms
Tool & Process Monitoring
Accessories

TAPER SHANKS AND MOUNTING FLANGES FOR PROBING SYSTEMS

Marposs developed a complete range of taper shanks and flange d'attacco for its probing systems on machining centres, milling machines, lathes and turning centres. In this document one can find information either for buying or for autonomous making of those accessories.

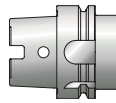
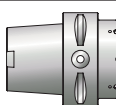
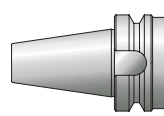
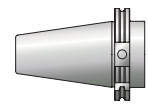
<i>mounting flanges</i>	
<i>VDI mounting flanges</i>	
<i>adapting flanges</i>	
<i>HSK shanks</i>	
<i>CAPTO shanks</i>	
<i>BT shanks</i>	
<i>ISO/CAT shanks</i>	



SHANKS AND FLANGES FOR SPINDLE PROBING

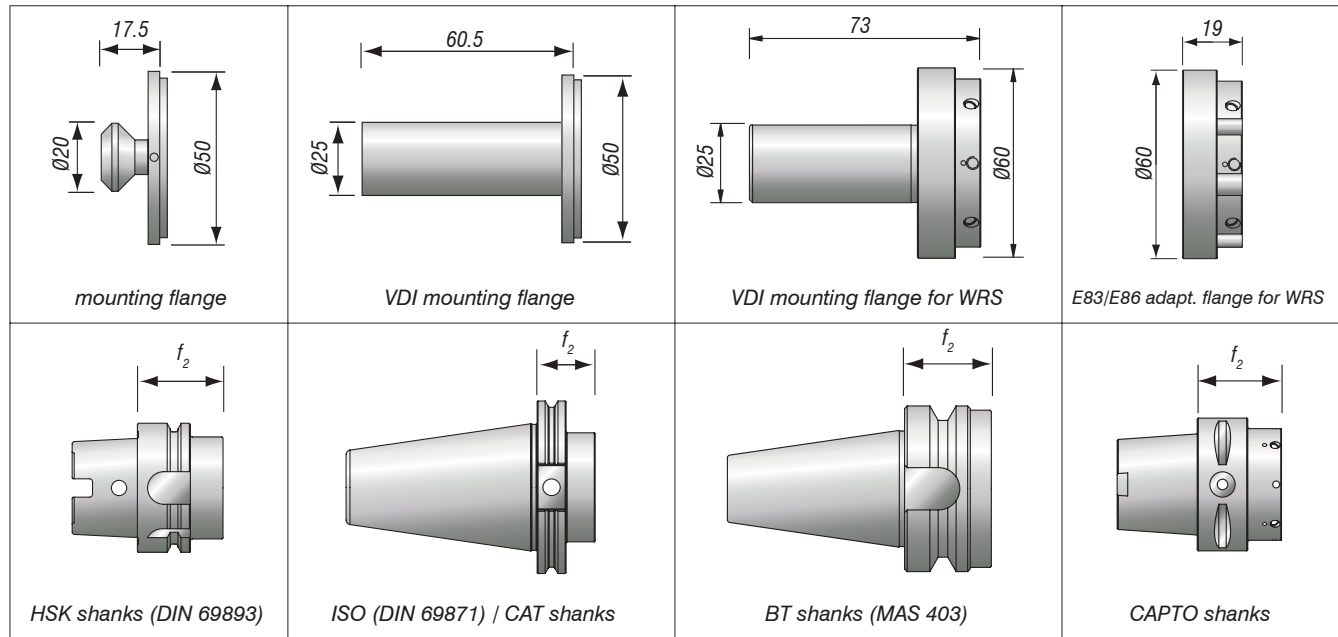

Product	TX code	Description	Shanks/ flange code	Description	quota f_2
E83L	6871831030 6871831011 6871831031	E83 TXL50 E83 TXL110 E83 TXL50 offset	2919933041 2919933061	Mounting flange with tang group VDI Ø25 mounting flange group	/
OP32	3427885000 3427885001	OP32	2027885010 2027885015 2027885016 2027885011 2027885012 2027885013 2027885014	HSK25 E shank group with XY adjusting HSK32 E shank group with XY adjusting HSK40 A shank group with XY adjusting BT30 shank group with XY adjusting BT40 shank group with XY adjusting ISO30 shank group with XY adjusting ISO40 shank group with XY adjusting	20 25 25 25 30 20.9 20.9
E83MC	6871832001 6871832011 6871832021 6871832023	E83MC 35° E83MC 70° E83MC 90° E83WA	4390190116 4390190143 4390190122 4390190106 4390190105 4390190126 4390190108 4390190109 4390190123 4390190112 4390190113 4390190125 4390190124	HSK40 A shank HSK40 E shank HSK50 A shank HSK63 A shank HSK100 A shank ISO30 shank ISO40 shank ISO50 shank BT30 shank BT40 shank BT50 shank CAT50 shank CAT40 shank	43 43 50 52 45 43 43 35 30 35 38 35 44.6
WRS	6871892000	WRP 45 RF	2027885064 2027885078 2027885050 2027885051 2027885074 2027885053 2027885075 2027885084 2027885085 2027885056 2027885057 2027885058 2027885059 2027885060 2027885061 2027885062 2027885063	E83/E86 WRS adapting flange group VDI flange group for WRP with XY adjusting HSK40 A+C shank group with XY adjusting HSK50 A+C shank group with XY adjusting HSK63 A+C air dual shank group with XY adjusting HSK80 A+C shank group with XY adjusting HSK100 A+C air dual shank group with XY adjusting HSK63 E shank group with XY adjusting HSK63 F shank group with XY adjusting CAPTO C5 shank group with XY adjusting CAPTO C6 shank group with XY adjusting CAPTO C8 shank group with XY adjusting ISO40 shank group with XY adjusting ISO50 shank group with XY adjusting BT30 shank group with XY adjusting BT40 shank group with XY adjusting BT50 shank group with XY adjusting	/ / 35 42 44 48 50 26 26 36 40 46 31.8 31.8 28 33 43

Fixing scheme for OP32

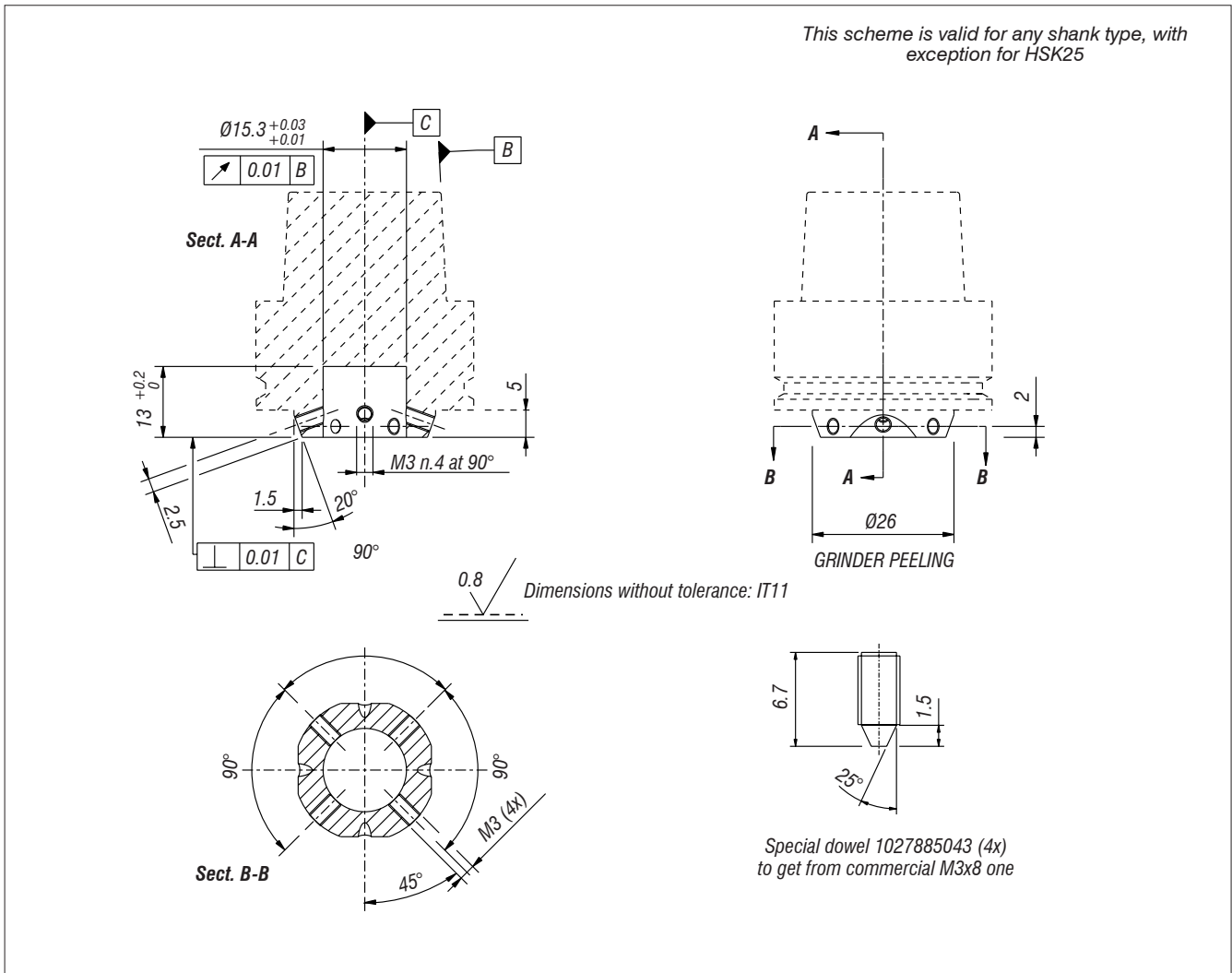

Fixing scheme for E83MC

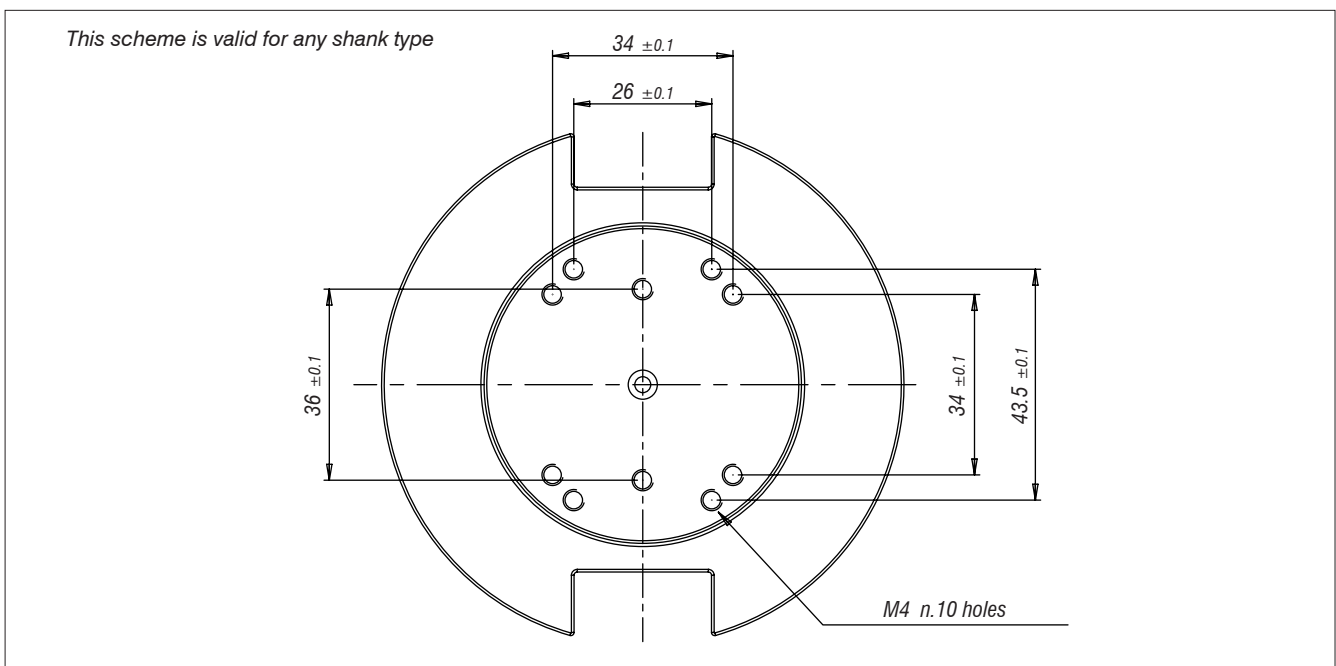

Fixing scheme for WRS

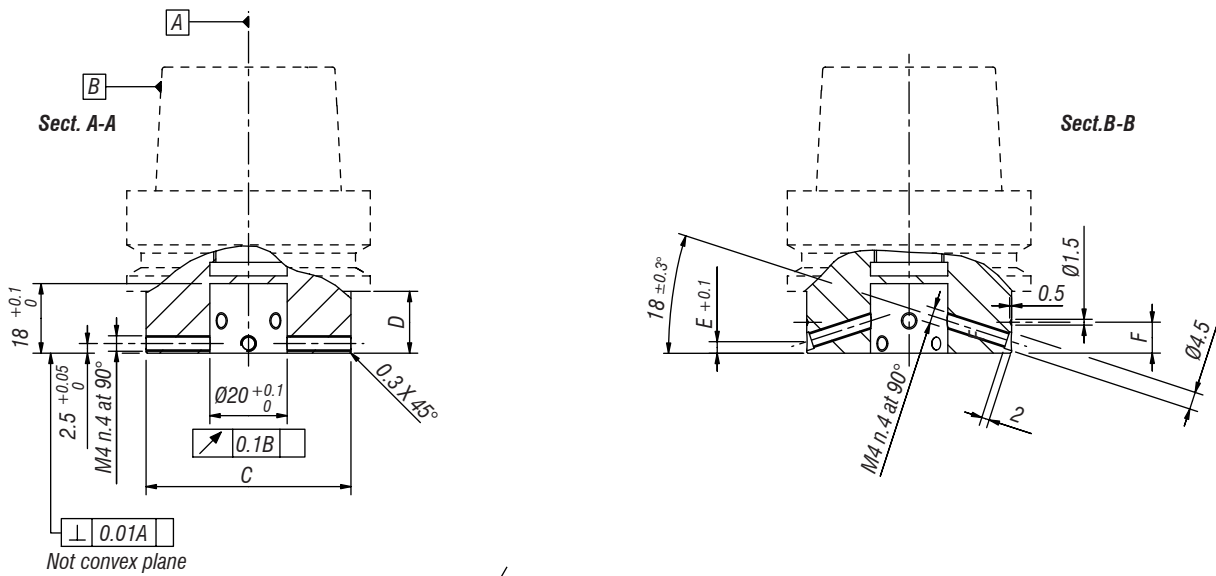

0.8
 Dimensions without tolerance: IT11

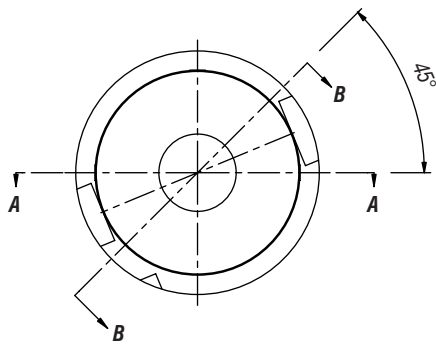

Shank description	C [mm]	D [mm]	E [mm]	F [mm]
HSK40 A+C	34	15	6.1	11
HSK50 A+C	42	16	4.8	10
HSK63 A+C	53	18	3	8
HSK80 A+C	53	22	3	8
HSK100 A+C	53	21	3	8
HSK63 E	53	18	3	8
HSK63 F	42	18	4.8	10
CAPTO C5	42	16	4.8	10
CAPTO C6	53	16	3	8
CAPTO C8	53	16	3	8
ISO 40	50	15.9	3.5	8
ISO 50	53	15.9	3	7
BT30	42	8	4.8	1.3
BT40	43	8	3	7
BT50	43	8	3	7



MARPOSS
www.marposs.com

For a full list of address locations, please consult the Marposs official website

D6C05900G0 - Edition 11/2011 - Specifications are subject to modifications
 © Copyright 2009-2011 MARPOSS S.p.A. (Italy) - All rights reserved.

MARPOSS, ® and Marposs product names/signs mentioned or shown herein are registered trademarks or trademarks of Marposs in the United States and other countries. The rights, if any, of third parties on trademarks or registered trademarks mentioned in the present publication are acknowledged to the respective owners.

Marposs has an integrated system to manage the Company quality, the environment and safety, attested by ISO 9001, ISO 14001 and OHSAS 18001 certifications. Marposs has further been qualified EAQF 94 and has obtained the Q1-Award.

