

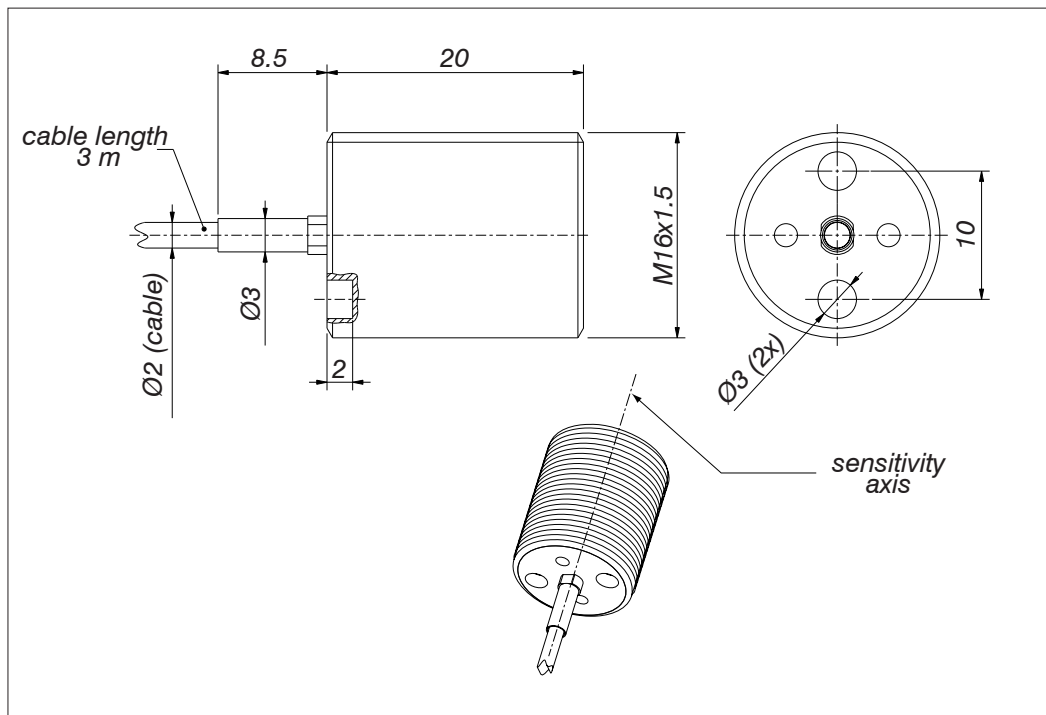

ACCELEROMETER



Technical data

Wiring diagrams

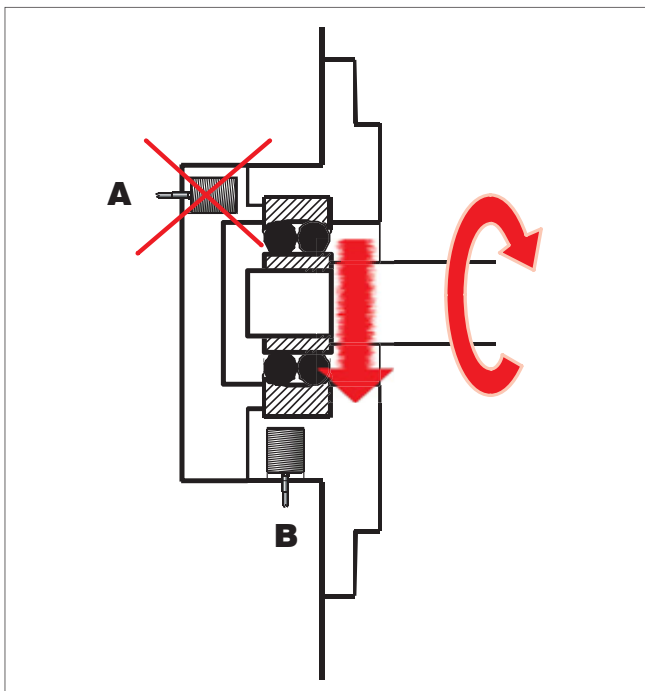
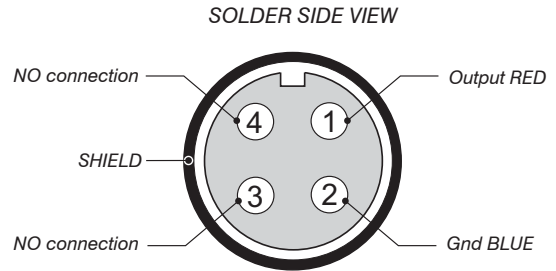
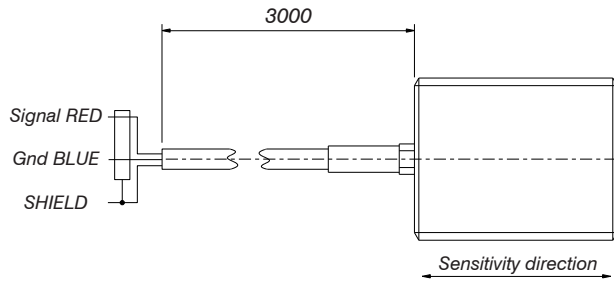

Selection of accelerometer mounting and fixing position

The accelerometer must be assembled so that the measuring direction is aligned with its main sensitivity axis (see arrow shown in fig.).

Using the example, where the acceleration measure monitors the shaft or bearing working conditions: the accelerometer "B" detects the vibration signal produced by the bearing, while the accelerometer "A" measures the vibrations produced by other machine components.

Technical specification

Sensor type	piezoelectric
Applicative feature	monoaxial
Dimensions	l = 20 mm - Ø = 16 mm
Sensitivity	100 mV/g* (± 20%)
Transversal sensitivity	< 5%
Frequency range	0.3 Hz ÷ 10 kHz
Resonance frequency	> 25 kHz
Measuring range	50 g*
Shock limit	7000 g*
Linearity error	≤ 1%

Power supply	2 ÷ 20 mA - 18 ÷ 28 Vdc
Output impedance	< 100 ohm
Operating temperature range	-5° ÷ 80°C
Cable length	3 m
Cable diameter	Ø2 mm
Thermal coefficient	0.18%/°C
Cable sheath material	EU (polyurethane-polyether)
Protection degree (IEC 60529 standard)	IP67

(*) = gravity acceleration value, corresponding about to ≈ 10 ms⁻²

For a full list of address locations, please consult the Marposs official website

D6C05000G0 - Edition 05/2013 - Specifications are subject to modifications
© Copyright 2009-2013 MARPOSS S.p.A. (Italy) - All rights reserved.

MARPOSS, ® and Marposs product names/signs mentioned or shown herein are registered trademarks or trademarks of Marposs in the United States and other countries. The rights, if any, of third parties on trademarks or registered trademarks mentioned in the present publication are acknowledged to the respective owners.

Marposs has an integrated system to manage the Company quality, the environment and safety, attested by ISO 9001, ISO 14001 and OHSAS 18001 certifications. Marposs has further been qualified EAQF 94 and has obtained the Q1-Award.



www.marposs.com



Download the latest version of this document



Touch Probes
Transmission Systems
Laser
Software
Toolsetting Arms
Tool & Process Monitoring
Accessories