

**MARPOSS**

# **M38** *Plus*

**MEASURING SYSTEMS FOR THE  
CV JOINT INSPECTION**





The M38 Plus line of inspection systems is accurate, flexible and right at home on the shop floor. The modular M38 Plus system is quickly retoolable using ordinary hand tools. You'll save time and the cost of dedicated gauges. No one has a more complete line of CV Joint checking equipment than Marposs, so every component is guaranteed compatible.

If you are looking for easier, more accurate CV Joint checking, take a look at the Marposs M38 Plus bench gauge system.

- M38 Plus Inner race
- M38 Plus Outer race
- M38 Plus Cage

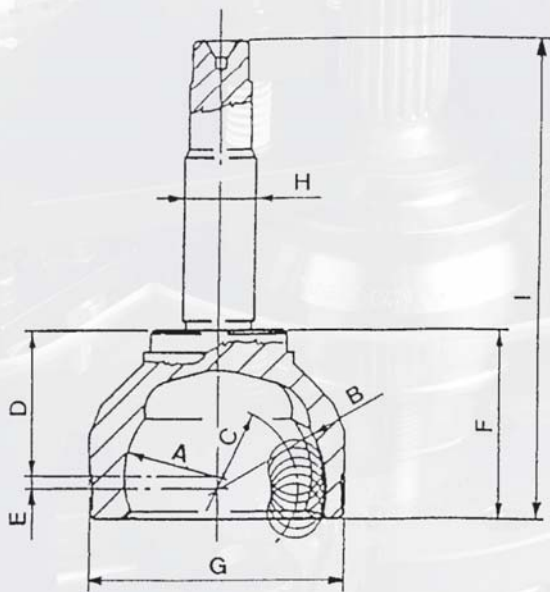
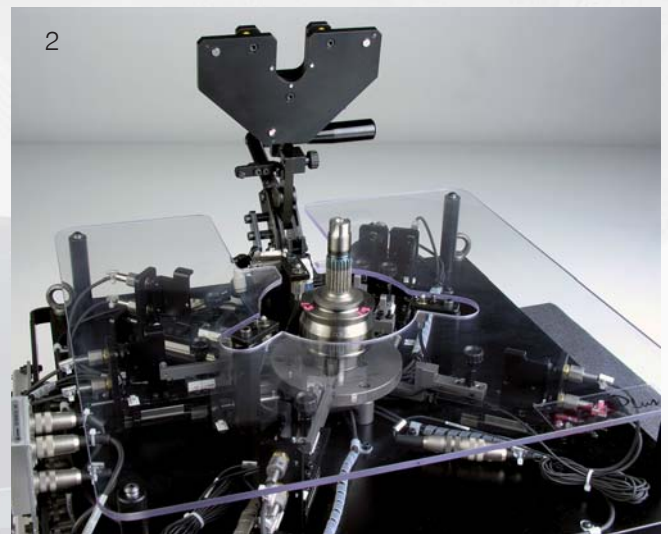
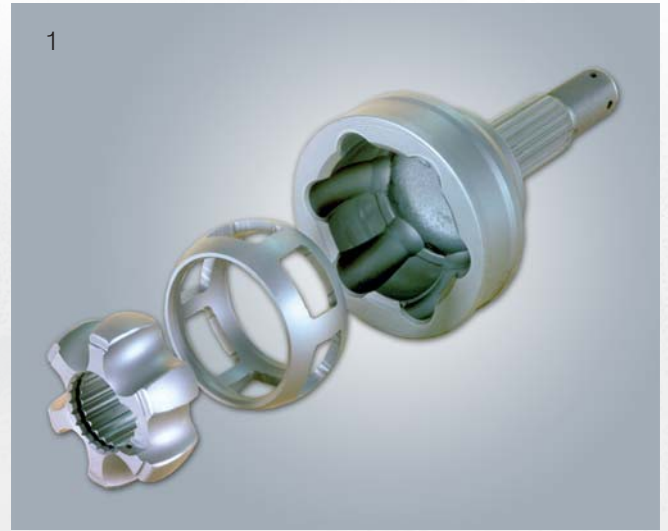

	A	B(*)	C(*)	D	E	F	G	H	I	Ø BALL SEAT
Min	26	31	24	36	3	48	72	24	125	14
Max	43	49	34	55	5	70	120	34	170	20

1. CV Joint components
2. Inner race inspection
3. Vertex clearance contact